

Marchwood, Hampshire, UK

completed June 2001

This modern townhouse of three storeys has a small west-facing rear garden. First and second floor balconies meant that the garden had to be interesting in plan view as well as from the kitchen at ground level.



Both clients work away during the week and needed a low maintenance garden with spaces to eat out and to work in. They also wanted a 'full', rich, planting treatment.



The design challenge was to create a stylish design that made the maximum use of the space and that would be interesting viewed from different floors of the house.



I interlocked an octagonal summerhouse with an octagonal patio, maximising the available space and creating a strong off-centre focus in the garden.

By raising the patio slightly, I aimed to create interest in a small space. I also extended the journey to the patio by creating a small staggered wooden bridge across a dry river bed.

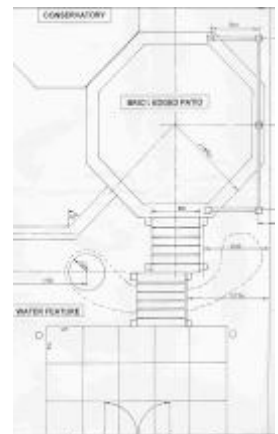

A range of shrubs (including box, Aucuba and bamboo) provides year-round structure and interest. Tan-coloured square trellis frames the patio and contrasts well with the planting, creating a subtly Oriental look.

^ This construction drawing shows the arrangement of the octagonal patio, wooden steps and dry river bed

