

## East Hampshire, UK

completed Summer 2005

This mid-Victorian flint and brick property stands in approximately one third of an acre of grounds on three sides. A new outbuilding and conservatory prompted the clients to review the design of the rear garden (in the first instance) and the side and front gardens later.

I was tasked with producing a modular design in a modern yet timeless style, sympathetic to the rural location and that would also link all three garden spaces seamlessly. My clients also had a sculpture and ornament collection which they wanted to display to the best effect in the new garden.

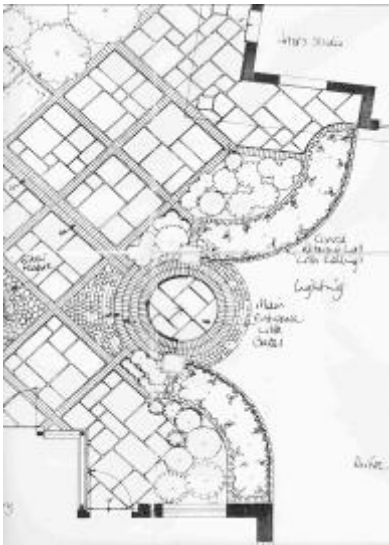

The principal design challenge was to take attention away from a 4m high conifer hedge along the northern boundary and directly opposite the conservatory. The hedge drew attention away from the garden and looked out of proportion to the rest of the space.

By opting for a formal design based on a 45 degree grid from the conservatory, I was able to make a link with the new outbuilding and provide a strong alignment that reduced the visual impact of the conifer hedge. Strong curves were also adopted in key entry points, such as the double gates, to soften the geometry and to provide a bold but graceful counterpoint to the formality created.

