

Exbury, Hampshire, UK completed Summer 2005

This Victorian mid-terrace property has an irregularly shaped back garden with a garage at the end.

The client wanted a restful space that would assist in meditation and reflection and also provide a calming backdrop to social and recreational activities in the morning and evening.

The design challenge was to take attention away from the boundary fencing and bring more interest to the rather flat and awkwardly shaped space.

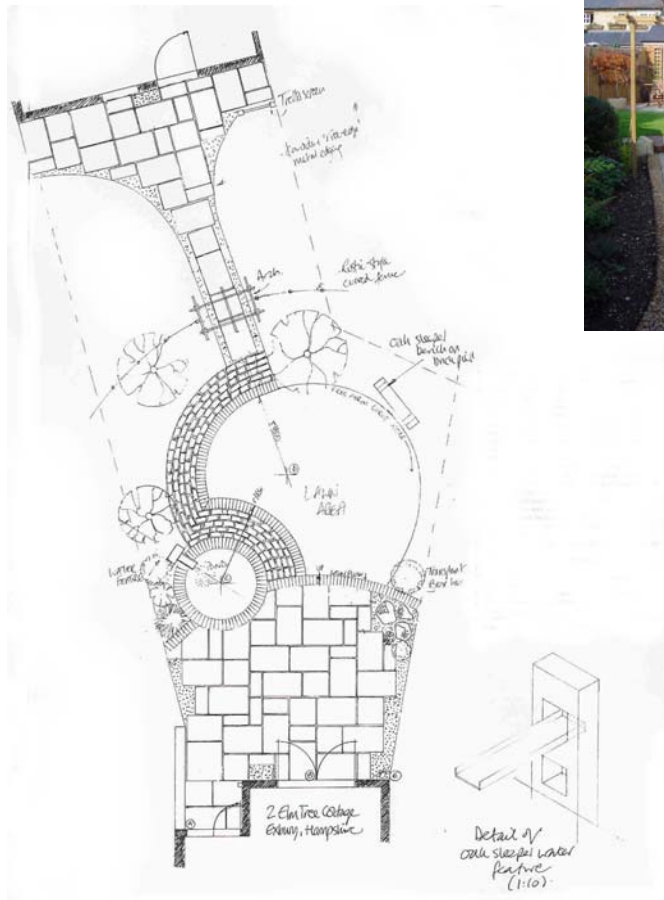

< A bespoke Japanese style birdbath made from zinc plates, chain and copper pipe and water feature made from an oak sleeper



The garden divided naturally into three spaces: the patio area, the lawn area and the 'lower' garden towards the garage outbuilding.

I adopted a circles and curves theme to bring attention to the centre of the space and to create a sense of flow and interest along the journey through the garden.

I used design principles from Japanese gardens to create a simple, balanced and uncluttered space.

I particularly like the interplay between circles and squares and also horizontal and vertical features: the oak beam bench echoes the oak beam water feature, for example.