

## Northam Tenants & Residents Association, Southampton

*Completed April 2005*

The residents association had access to a small courtyard behind their meeting place and wanted to develop it into a garden. Many of the residents had gardening skills and had stories to tell of their gardening exploits in a challenging, high rise environment.



*A place to sit and chat under the multi-coloured pergola*

The design challenge was to create an oasis in a heavily built up and oppressive area that enabled the residents to feel that they were in a real garden.

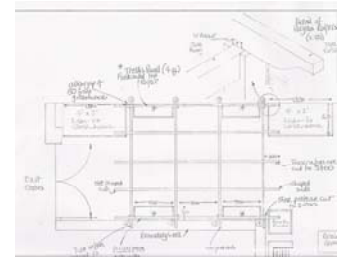

Ultimately, my aim was to provide an adaptable gardening space that allowed garden visitors to grow vegetables and other seasonal crops.

The L-shaped space lent itself to division into two separate spaces. To 'bring down' the oppressively high

walls, we painted them up to a certain height (6') to allow the eye to travel up to a certain line.

A wooden pergola also softened the harshness of materials and was painted in a green and red colour combination. The walls were painted in a mixed colour of cream and terracotta to give a soft pinky-orange. This colour sets off the foliage and plants remarkably well.

*Vegetable crops thrive in this inner city garden, surrounded by high walls*

All sorts of containers were co-opted into the garden creating a real treasure trove feel where the delight is in the observations you make as you look at the various containers, pots and hanging baskets.

The success of this garden is not only measured in the plants that thrive here but in the delight and the joy in the faces and gestures of the residents who tend to their little oasis.

